

Cleaning System TankMaster® S-1500

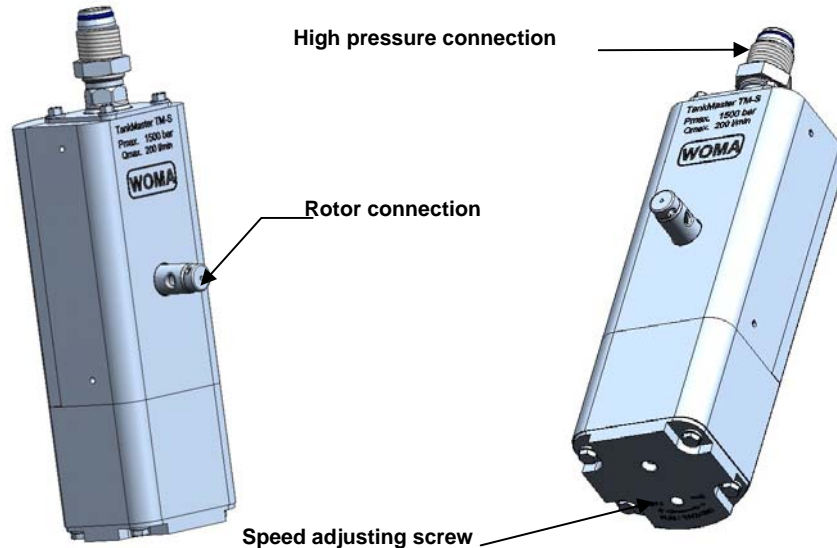

Description:

The cleaning system TankMaster S-1500 is a highly efficient water tool for cleaning the interior of tanks, containers, vessels and autoclaves in the chemical industry.

The TankMaster can be customized to your tank sizes with different rotor options and extension arms.

Special characteristics:

Optimization of cleaning results due to special gear drive design.

Proven sealing system, hardened gears and the use of a slipping clutch make this a long life nozzle.

Easily adjustable magnetic brake system allows control over rotational speed.

Housing and parts under high pressure made of stainless steel.

Technical data:

Part-No.:	342.0101
Operating pressure :	max. 1500 bar
Medium temperature:	max. + 95°C
Weight without rotor:	appr. 12 kg
Nominal width:	12 mm
Nominal flow rate:	appr. 200 l/min
Recommended nozzles:	Form 4
No. of nozzles:	2 pieces
Rotor speed:	15 up to 65 1/min
Height:	appr. 337 mm
Smallest required opening diameter:	φ 125 mm

Cleaning System TankMaster® S-1500

Components

HP – Hose connection		
Part-No.:	Thread A	Nominal DN mm
180.2362	M24 x 1,5	12
180.2364	M36x2	20

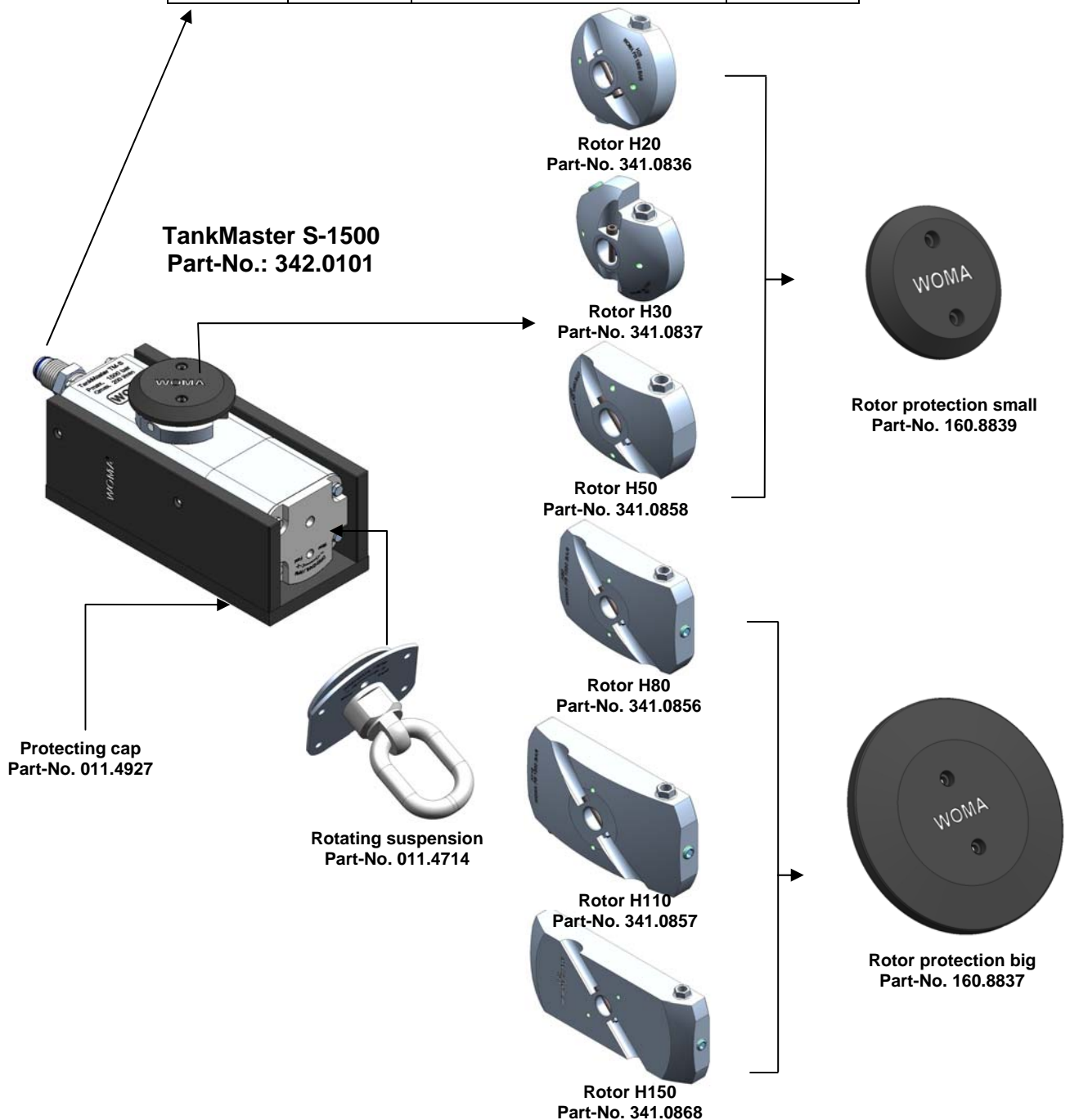

Rotor and rotor speed selection diagram – Tankmaster S-1500

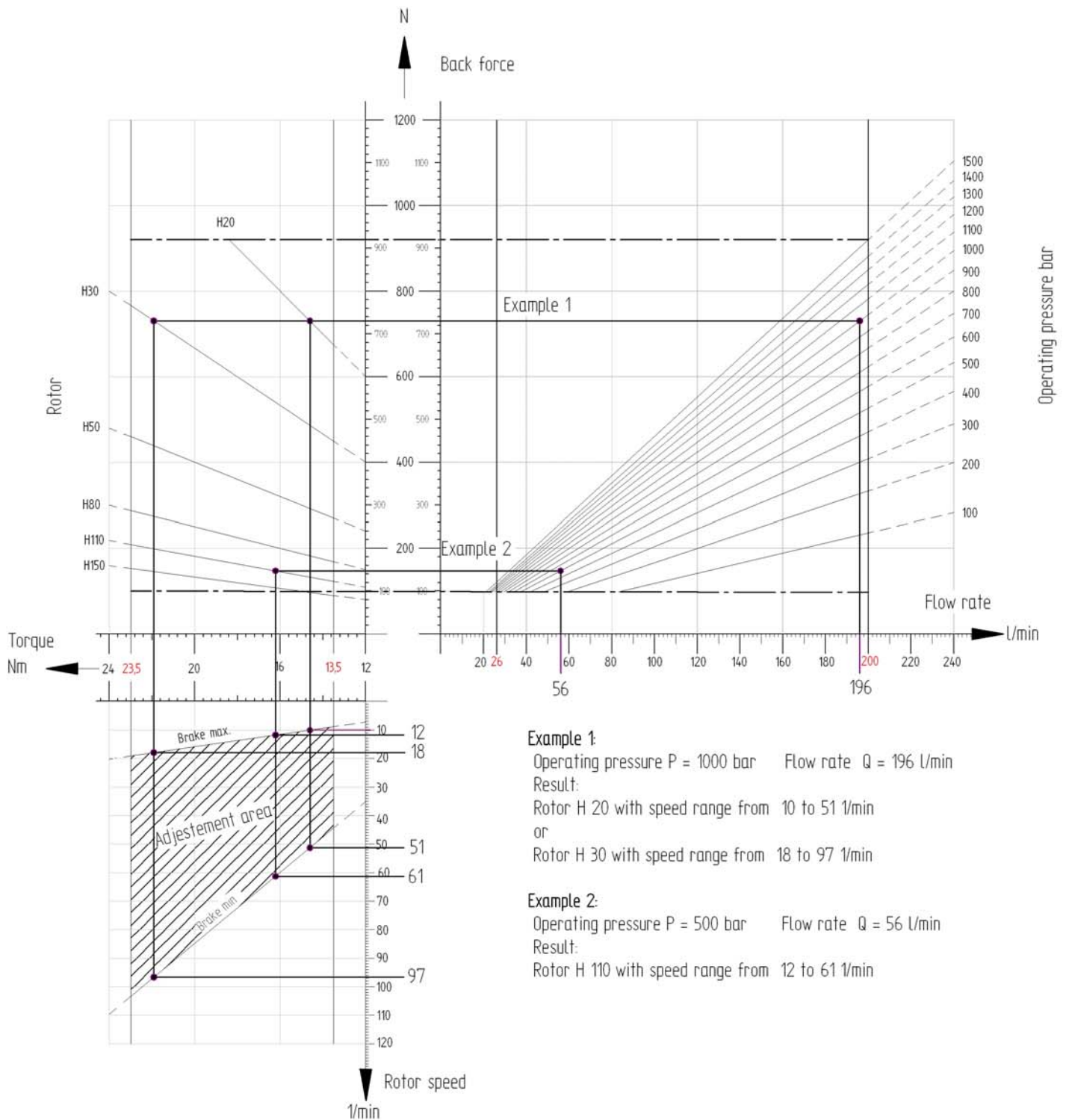

Selection charts for nozzles – nozzle form 4

2x Part-No.	Nozzle ø (mm)	Rotor H20														
		Operating pressure - bar														
		100	200	300	400	500	600	700	800	900	1000	1100	1200	1300	1400	1500
Flow rate - l/min for 2 nozzles form 4																
340.0404	1,8															151
340.0429	1,9														162	168
340.0405	2,0											166	173	180	186	
340.0406	2,2										184	193				

2x Part-No.	Nozzle ø (mm)	Rotor H30														
		Operating pressure - bar														
		100	200	300	400	500	600	700	800	900	1000	1100	1200	1300	1400	1500
Flow rate - l/min for 2 nozzles form 4																
340.0403	1,5															105
340.0420	1,6													111	115	119
340.0419	1,7											120	125	130	134	
340.0404	1,8										123	129	135	140	145	151
340.0429	1,9									130	137	144	150	156	162	168
340.0405	2,0								136	144	151	159	166	173		
340.0406	2,2							154	164	174	184	193				
340.0484	2,3								168	179	190	200				
340.0407	2,4						169	183	195							
340.0408	2,5						184	198								
340.0485	2,7					196										

2x Part-No.	Nozzle ø (mm)	Rotor H50														
		Operating pressure - bar														
		100	200	300	400	500	600	700	800	900	1000	1100	1200	1300	1400	1500
Flow rate - l/min for 2 nozzles form 4																
340.0402	1,2														65	67
340.0421	1,3											70	73	76	79	
340.0418	1,4										74	78	81	85	88	91
340.0403	1,5										81	85	90	94	97	101
340.0420	1,6								87	92	97	102	106			
340.0419	1,7							92	98	104	110	115				
340.0404	1,8						95	103	110	117	123					
340.0429	1,9						106	115	122	130						
340.0405	2,0					107	118	127	136							
340.0406	2,2				116	130	142									
340.0484	2,3				127	142	155									
340.0407	2,4				138	155										
340.0408	2,5				150	168										
340.0485	2,7			151	175											
340.0409	2,8			163	188											
343.0405	2,9			175												
340.0410	3,0			187												
340.0411	3,2		174													
343.0404	3,3		185													

2x Part-No.	Nozzle ø (mm)	Rotor H80														
		Operating pressure - bar														
		100	200	300	400	500	600	700	800	900	1000	1100	1200	1300	1400	1500
Flow rate - l/min for 2 nozzles form 4																
340.0426	0,9															38
340.0401	1,0															47
340.0428	1,1										46	48	50	52	54	56
340.0402	1,2									52	55	57	60	62	65	
340.0421	1,3								57	60	64	67	70			
340.0418	1,4							62	67	71	74					
340.0403	1,5						66	71	76	81						
340.0420	1,6					69	75	81	87							
340.0419	1,7					78	85	91								
340.0404	1,8				78	87	95									
340.0429	1,9				87	97										
340.0405	2,0			83	96	107										
340.0406	2,2			101	116											
340.0484	2,3			110												
340.0407	2,4			120												
340.0408	2,5		106	130												
340.0485	2,7		124													
340.0409	2,8		133													
343.0405	2,9		143													
340.0410	3,0		153													
340.0411	3,2		174													
343.0404	3,3															
340.0412	3,5	147														
343.0403	3,6	156														
340.0413	4,0	192														
340.0415	4,5															

2x Part-No.	Nozzle ø (mm)	Rotor H110														
		Operating pressure - bar														
		100	200	300	400	500	600	700	800	900	1000	1100	1200	1300	1400	1500
Flow rate - l/min for 2 nozzles form 4																
340.0447	0,8														29	30
343.0401	0,85														32	33
340.0426	0,9											32	34	35	36	38
340.0401	1,0									36	38	40	42	43	45	47
340.0428	1,1							41	44	46	48	50				
340.0402	1,2						46	49	52	55						
340.0421	1,3					50	54	57								
340.0418	1,4				53	58	62									
340.0403	1,5			54	60	66										
340.0420	1,6			61	69											
340.0419	1,7			69	78											
340.0404	1,8			67	78											
340.0429	1,9			75	87											
340.0405	2,0			83												
340.0406	2,2		82	101												
340.0484	2,3		90													
340.0407	2,4		98													
340.0408	2,5		106													
340.0485	2,7		124													
340.0409	2,8															
343.0405	2,9															
340.0410	3,0	108														
340.0411	3,2	122														
343.0404	3,3	131														
340.0412	3,5	139														
343.0403	3,6	156														

2x Part-No.	Nozzle ø (mm)	Rotor H150														
		Operating pressure - bar														
		100	200	300	400	500	600	700	800	900	1000	1100	1200	1300	1400	1500
Flow rate - l/min for 2 nozzles form 4																
340.0447	0,8										24	25	27	28	29	30
343.0401	0,85									26	28	29	30	31	32	34
340.0426	0,9								27	29	31	32	34	35		
340.0401	1,0							32	34	36	38	40				
340.0428	1,1						36	38	41	44						
340.0402	1,2					39	42	46								
340.0421	1,3				41	45	50									
340.0418	1,4				47	53										
340.0403	1,5			47	54											
340.0420	1,6			53	61											
340.0419	1,7			60												
340.0404	1,8		55	67												
340.0429	1,9		61	75												
340.0405	2,0		68													
340.0406	2,2		82													
340.0484	2,3		90													
340.0407	2,4															
340.0408	2,5															
340.0485	2,7	87														
340.0409	2,8	94														
343.0405	2,9	101														
340.0410	3,0	108														
340.0411	3,2	122														
343.0404	3,3	131														
340.0412	3,5															
343.0403	3,6															